

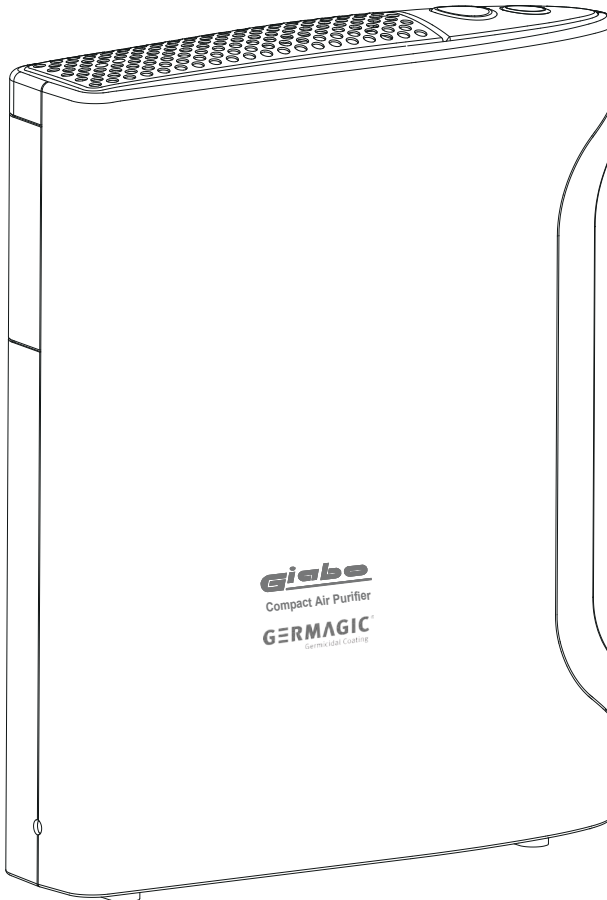

Instruction Booklet
PAC0600 Compact Air Purifier
with Nano PCO, Plasma Ionizer
and Germagic Filter



Safety Instructions

When using electrical appliances, basic safety precautions should always be followed, including the following:

1. This appliance is designed for household use only. Do not use outdoors or for commercial and/or industrial purposes.
2. Use this appliance only for its intended purpose as outlined in this manual.
3. Please remove the plastic bag of filters before use.
4. To protect against electric shock, do not immerse Adaptor cord, plug or appliance in water or other liquid.
5. Plug AC/DC Adaptor into a properly wired power socket.
6. Not recommend to use the same wall outlet with any other electrical appliances to avoid power overloading.
7. Children should be supervised to ensure that they do not play with the appliance.
8. Unplug the appliance when not in use or before cleaning.
9. If the supply cord or Adaptor is damaged, it must be replaced by the manufacturer, its service agent or similarly qualified persons in order to avoid a hazard.
10. This appliance is not intended for use by persons (including children) with reduced physical, sensory or mental capabilities, or lack of experience and knowledge, unless they have been given supervision or instruction concerning use of the appliance by a person responsible for their safety.
11. The appliance must be operated on a flat surface and away from the edge of a counter or table to avoid accidental tipping over.
12. The use of accessory attachments that have not been approved by the appliance manufacturer is not recommended, as this may result in fire, cause an electric shock and/or cause personal injury.
13. Ensure your hands are fully dried before plugging or unplugging the appliance.
14. Use damp cloth only, do not clean with strong chemical agent or other abrasive materials.

Indoor Pollutants

- VOC (Volatile Organic Compounds)-VOC comes from motor vehicle exhaust, gasoline vapor and chemical solvents like paints and glues. VOC irritates eyes or noses, causes headaches, nausea, and even damage to the central nervous system. Pressed wood furniture, newly decorated room, paint and cleaning solvents are common sources of VOC'S.
- MOLD / FUNGI - found in most of homes that affect our respiratory system and cause allergic reactions, like running nose, eye and throat irritation, head aches, fatigue and aggravation of asthma.
- Odour - Tobacco smoke, glues, aerosol sprays, unpleasant odours, pet odours and dander.
- Other contaminants - bacteria, virus, dust mites, pollen, etc.
- Emissions from electronic office equipment – Many studies including EPA, University of California Berkeley and Australian researchers reported that emissions coming from many office equipment, computers and printers including VOC's , ultra-fine particles, and especially ozone are harmful to our health.

Introduction to using filters and PCO technology

- An effective filter is absolutely necessary to trap the particles down to microscopic size , and not to spread again into air stream the untreated airborne particles and bacteria.
- PCO system effectively removes VOC's, odour , bacteria and ozone when air passes by.
- Plasma ionization has the ability to inactivate airborne bacteria in ambient at a distance.



Warning

1. Keep Out of Reach of Children. Children being supervised not to play with the appliance.
2. Do not use rough cleansers, steel wool pads or other abrasive materials on your Air Purifier.
3. Keep your Air Purifier away from heat sources, direct sunlight or open flames.
4. Do not use this product if it has a damaged AC/DC adaptor, cord or plug, or not working properly. Do not try to self-repair, as this will invalidate your warranty.
5. Always unplug the Adaptor from power source under service or when not in use.
6. Never open the Door when the unit is on. The device shall turn inoperative once the door is not in completely closed position.

Operation Instructions

1. The device can be placed in upright or lay flat position, see picture (1) (2).
2. Keep clear of air inlet and outlet at operation, do not place any heavy object on top at any time.
3. Plug into local power socket with the provided AC/DC Adaptor and the DC plug at another end into the DC jack of the device (see picture 3), the standby red light shall be on.
4. Press the On/Off switch button to actuate the device, starting with fan speed 1. Press again to actuate Fan Speed 2. The green LED next to the speed indication shall be on once selected.
5. One more press on On/Off switch button shall turn off the device to standby mode.
6. Press Plasma Ionizer switch button to turn on and off the ionization. When ionization is in operation, the blue LED shall be on.



(1) in Lay Flat Position
(Door facing downward)



(2) in Upright Position

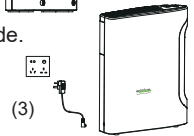

(3)

Replacing Filters and UV Lamp

How to remove the Filters and UV lamp for cleaning and replacement

1. Unplug the AC/DC Adaptor from power socket.
2. Open the Door by pressing on the arrow mark and then open outward.
3. To replace the Filter: pull the filter out by the inside end of it. When putting back a new filter in, ensure the "front" side is facing outward.
4. To remove the Pre-filter for cleaning: pull the filter out by the inside end of it, and take out the spongy pre-filter as indicated in picture (3). Wash pre-filter under running water, leave it dry in open air and put it back on "Front" side of the filter.
(Note: Germagic filter is not washable, keep dry at all times.)
5. To remove the PCO Filter for cleaning and replacement: Remove high performance Filters as instructed. Grip lightly at both ends of the PCO filter, pull it out gently and wash it under running water. Leave it dry under open air and put carefully it back in proper position. Never put it back in the device when it is still wet.
6. To replace the UV lamp: remove PCO filter as above, grip both ends of UV lamp and pull carefully out from the chamber. Hold tightly the UV lamp socket with one hand, and disconnect the lamp by pulling the plug of the lamp from socket as shown.

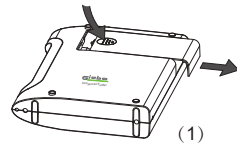

(1)

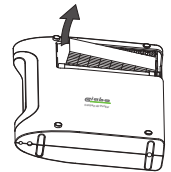

(2)

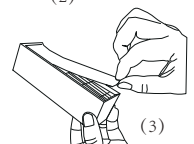

(3)

Replacing Filters and UV Lamp(Continue)

Replace with a new lamp by holding the lamp socket, then insert lamp plug all the way into the socket . Hold the lamp horizontally and slide it back into position. See the picture(4), (5)
Do not touch the lamp body at any time.

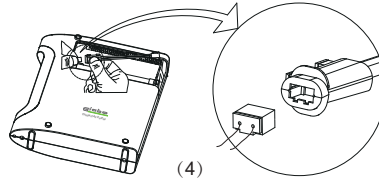

7. Make sure all the parts are in their proper place before closing the door.
8. The device shall not be turned on if the door is not closed completely.

Care and Cleaning

1. Before cleaning / maintenance, ensure the unit is switched off and unplugged for an hour.
2. Wipe all plastic parts with a damp cloth. for any stubborn stain, use mild / diluted detergent.
3. Replace UV Lamp by following "Replacing UV Lamp" procedure.
4. Nano Ti-oxide PCO filter can be washable. Install in its position after cleaned & dry.
5. Use only mild cleaning detergent solution to rinse PCO-filter. Make sure it is dry before use.
6. Ensure all replacement parts are dry before use.
7. Do not immerse the unit in any liquid.
8. Do not clean with strong chemical detergent or abrasive material at any time.

Limited Warranty

1. Please keep the original invoice for maintenance service.
2. If the appliance malfunctions or has been damaged in any manner, do not try to replace it. Return the appliance to our customer service centre for inspection, repairs or adjustments.
3. This warranty is valid for 18 months from the date of purchase. During the validity of this warranty, our customers will be entitled to free services. However, this warranty does not cover in the following conditions:
 - 3.1 Damage caused by accident, negligence, abuse, misuse, improper voltage, normal wear and tear or any unauthorized repair or being tampered.
 - 3.2 For commercial or industrial use.
 - 3.3 Use for other than intended use.
 - 3.4 Replacement parts not under warranty, they will be charged at cost.
 - 3.5 No valid sales invoice is presented. The invoice should be printed the name of dealer, model number and purchase date.
4. The warranty is valid only in the local city of purchase.

WEEE



This product contains recyclable materials. Do not dispose this product as unsorted municipal waste. Please contact your local municipality for the nearest collection point.

Model: PAC 0600
Rating: 12V DC 11W

Hong Kong Office:
CHIAP HUA INTERNATIONAL LIMITED
2 Dai Wang Street, Tai Po Industrial Estate, Tai Po, N.T., Hong Kong
Service Hotline: (852) 23700121

P.T.O. for Product Description to re-order refill parts.

使用手冊

PAC0600

精巧型空氣淨化機

採用光觸媒，正負等離子淨化系統
及Germagic(霉菌滅) HEPA濾網

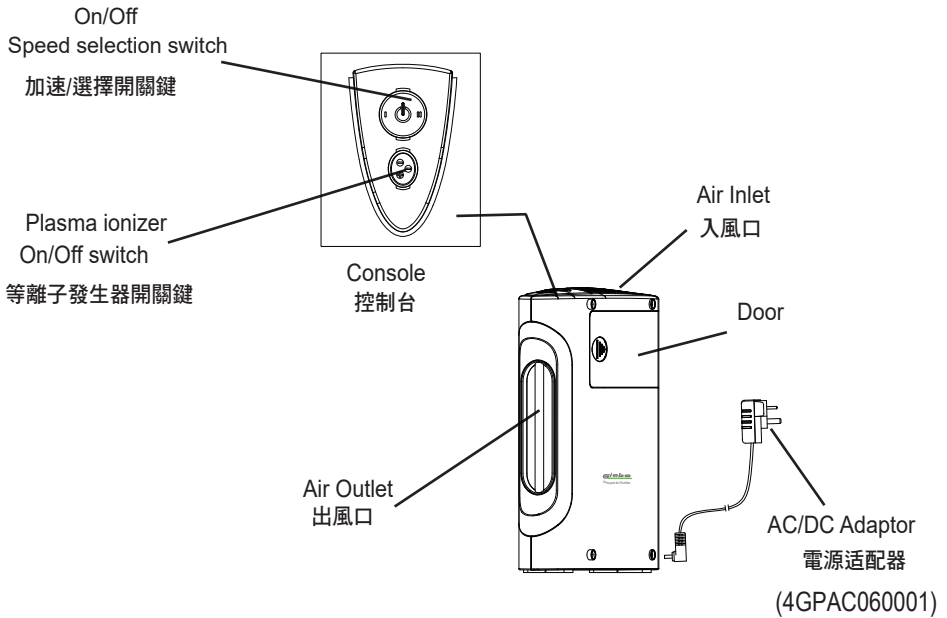

PCO Filter
PCO過濾器



(Z-PAC060001)

Germagic Filter
霉菌滅過濾網

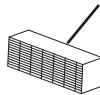

(K73-PAC0600-HE)

UV Lamp
紫外光燈



(5G9PAC060001)

安全注意事項

使用本產品時，必須遵循基本的安全措施，請仔細閱讀下列各點：

1. 本產品的設計為家居使用，切勿於戶外使用或作商業及工業用途。
2. 除說明書指定用途外，請勿使用本產品作其他用途。
3. 第一次使用前，請除掉高效過濾器的保護膠袋。
4. 為避免觸電，請確保適配器線、電源插頭、機身等，不被浸於任何液體中。
5. 請把適配器插入與之相適合的電源插座。
6. 切勿與其他電器共用同一個插座，以免電力負荷過重。
7. 請勿讓兒童單獨使用本產品。
8. 不使用本產品時或維護清潔前，請關掉電源，並拔出電源插頭。
9. 為避免意外，如果適配器已損壞，請與指定的製造商、服務代理經銷點或有資格的單位購買更換。
10. 除非在其監護人的監督和指導下，以下人員(包括小孩)不允許單獨使用本產品：身體體質差、感觀和精神失常、智力缺乏者或缺少相應經驗和知識者。
11. 請在平面地方操作本產品，並遠離桌邊或櫃邊，以防止碰跌。
12. 使用不經製造商認可之零件及配件可能會導致火災、觸電或人身損傷。
13. 插入或拔出電源插頭時，請保持雙手乾爽。
14. 清潔時，請使用溫和和清潔用品，切勿使用強化學性或具磨損性清潔用品。

空氣中的有害物質

- **VOC (Volatile Organic Compounds)**揮發性化合物 - 汽車排出的廢氣、電油、化學溶劑（如油漆、混合膠等），所釋放出的有害臭味，會令雙眼及呼吸系統等感到不適，甚至引起頭痛、哮喘、嘔吐，嚴重會引致神經中樞系統受損等症狀。很多專家認為，VOC潛伏於新傢具及裝修後的室內環境，對人體會產生直接影響。
- **MOLD / FUNGI** 霉菌 - 霉菌所釋放的孢子隨空氣流動，能長時間懸浮於空氣中，遇上適合的溫度和濕度，霉菌便迅速生長。霉菌會引致鼻敏感、眼睛刺痛、咳嗽、哮喘等病徵。
- 臭味 - 煙味、空氣不流通所產生的異味、動物發出的異味等。
- 其他空氣中的污染物 - 細菌、病菌、塵蟎、花粉等。
- 辦公電子設備的輻射。眾多權威機構研究報告指出，許多辦公設備如電腦及打印機產生的輻射，尤其是臭氧會嚴重損害人體健康。

納米二氧化鈦技術簡介

- 高效過濾器層完全可以吸附細至肉眼看不到的微塵，使之無法再擴散於空氣中。
- 光觸媒系統可有效消除空氣中的揮發性有害化合物，細菌、異味、臭氧等。
- 正負等離子發生器可殺死一定範圍內懸浮於空氣中的細菌。



警告

1. 產品須放置在兒童不易接觸到的地方。看護好兒童們不要把本產品當玩具玩耍。
2. 切勿使用強化學性清潔劑或具磨損性物件清潔本產品。
3. 讓本產品遠離火源、曝曬及熾熱環境。
4. 如果產品的電源適配器或電源線損壞，或產品不能正常運行，請不要繼續使用。請勿自行拆卸和維修本產品，這將會使保修無效。
5. 維護或不使用時，請斷開電源。
6. 產品正在運行時請勿打開門。內置自動裝置，當門沒有完全關閉，產品無法運行。

操作指引

1. 本產品有平躺和豎立兩種放置方式。見圖（1）和（2）
2. 為保證入風和出風順暢，請勿放置任何物件堵塞入風口和出風口。
3. 將AC/DC适配器的插頭插入標準電源插座，适配器的另一頭插入產品連接孔。見圖（3）這時紅色待機指示燈亮起。
4. 輕按開關按鈕一下，啟動第一檔風速。再按一次進入第二檔風速。選擇風速後，旁邊綠色指示燈亮起。
5. 第三次按下開關按鈕時，自動轉到待機模式，紅燈亮起。
6. 等離子發生器按鈕用以開啟和關閉離子發生器裝置。當等離子發生器啟動時，藍色指示燈亮起。



圖 (1) 平躺放置方式
(門朝下)



圖 (2) 豎立放置方式

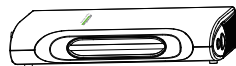

圖 (3)

更換過濾器及UV燈

1. 拔掉電源適配器切斷電源。
2. 如右圖（1），按住背面的門然後順著箭頭方向向外推，把門推出。
3. 更換Germagic (霉菌滅) 過濾器：如右圖2，輕按過濾器末端稍微向裏推，然後按箭頭方向取出過濾器。放置新過濾器時請注意“front”一面向外。
4. 清洗過濾器海綿：依第3點的方法取出過濾器，把過濾海綿輕輕撕下來。見圖（3）在流動清水下清洗海綿。洗淨的海綿請放置在通風處晾乾，再放回過濾器上。按第3點的方法把過濾器放回機身內。
(注意：Germagic (霉菌滅) 過濾器不能清洗，請隨時保持乾爽。)
5. 更換或清洗PCO過濾器：先取出高效過濾器以便取出PCO。輕輕地抓住PCO過濾器的兩端小心取出來，在流動清水中清洗乾淨。清洗過的PCO過濾器需放在通風處晾乾後才能重新放回機身相應位置。PCO過濾器未完全晾乾時，切勿放入機身內。
6. 更換UV燈：取出PCO過濾器，握住UV燈兩端小心地從裏面拉出來。

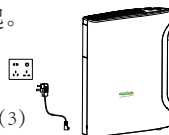

圖 (1)



圖 (2)



圖 (3)

更換過濾器及UV燈（續）

如圖4所示，緊握UV燈座拔出燈管。

換上新燈管，確保燈座正確插在電源座裏。如圖5所示，雙手平握UV燈的兩端平穩地放入機身內。任何時候請勿觸摸到燈管身。

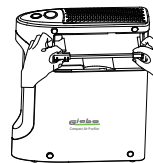
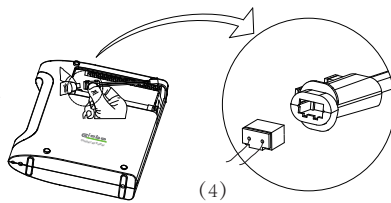

7. 重新扣上門之前，請確保所有的物件都已裝好。
8. 如果門沒有完全扣合，產品將無法運作。

(5)

保養方法

1. 清理前，請確保本產品已關掉，並拔出電源插頭。等候1小時待此機冷卻。
2. 用微濕布抹拭機身表面，如有頑固污漬，可用濕布加入適量清潔液清理，然後用清潔布抹淨。
3. 過濾網需經常清理。請先從機上拆下清理，可使用稀釋清潔液及清水沖洗，風乾後，便可循環使用。
4. 納米二氧化網可長久使用，不易刮花及剝落。請使用清水沖洗後風乾妥當，以保持除味滅菌效用。
5. 按"更換紫外光燈管"程式，先把燈管拆下來清理，抹去塵埃。
6. 所有上述配件於清理後，需待乾透後，才可裝回使用。
7. 本產品後門及前置過濾網，可放入清水直接清洗。其餘部份，包括機體電源線及插頭，切勿浸於任何液體中。
8. 切勿使用強化學性或磨損性的清潔劑，清洗任何部份。

保修

1. 請保留銷售發票，於維修時提供查閱。
2. 請勿自行維修或更換零件，如有任何需要，請帶同本產品及銷售發票到捷家伴維修中心檢修或調校。
3. 顧客在購買之日起計18個月內可享有免費維修服務，唯在下列情況下則不在此保用範圍內：
 - 3.1 意外、疏忽、使用不當或濫用、輸入不合適電壓、正常日久使用損耗及任何擅自修理或改裝所造成的損壞。
 - 3.2 用於商業或工業用途。
 - 3.3 用於非指定用途。
 - 3.4 使用非指定或提供之配件。若更換主要零配件，需酌收基本費用。
 - 3.5 未能提供有效銷售發票 - 發票需印明銷售商舖資料、型號及購買日期。
4. 保養服務只在購買所在地區有效。

 本產品包含有可循環材料，請勿將其廢品置於未分類垃圾場所。

型號： PAC 0600
額定： 12V DC 11W

香港總辦事處：
捷和國際有限公司
香港大埔工業邨大宏街2號
聯絡電話：(852) 2370 0121